

vtech[®]

Parent's Guide

Ride & Go Recycling Truck



VTech understands that a child's needs and abilities change as they grow and with that in mind we develop our toys to teach and entertain at just the right level...

vtech Baby

Toys that will stimulate their interest in different textures, sounds and colours

I am...

...responding to colours, sounds and textures

...understanding cause and effect

...learning to touch, reach, grasp, sit-up, crawl and toddle

Birth-36 months



Pre-School

Interactive toys to develop their imagination and encourage language development

I want...

...to get ready for school by starting to learn the alphabet and counting

...my learning to be as fun, easy and exciting as can be

...to show my creativity with drawing and music so my whole brain develops

3-6 years



Electronic Learning Computers

Cool, aspirational and inspiring computers for curriculum related learning

I need...

...challenging activities that can keep pace with my growing mind

...intelligent technology that adapts to my level of learning

...National Curriculum based content to support what I'm learning at school

4-10 years



To learn more about this and other VTech® products, visit www.vtech.co.uk

INTRODUCTION

Thank you for purchasing the **Ride & Go Recycling Truck!** Take a ride and learn about recycling and the environment! Pick up blocks and sort them by shape and colour, then store them inside the truck.

12 Recycling Buttons

3 Smart
Sorting Bins

3 Lights

Mode Switch

Ignition Key



Horn Button

Off/Low/High
Volume

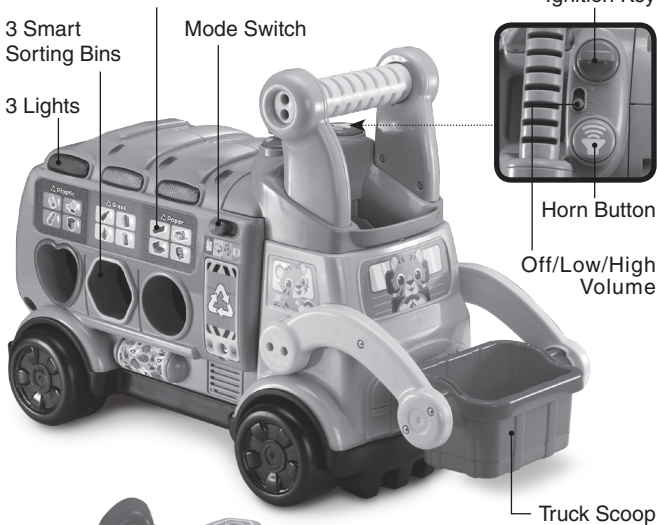

Truck Scoop



6 Blocks

INCLUDED IN THE PACKAGE

- Ride & Go Recycling Truck



- 6 Blocks



- Label sheet

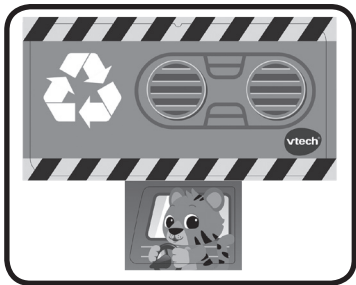

- Parent's Guide

WARNING

All packing materials such as tape, plastic sheets, packaging locks, removable tags, cable ties, cords and packaging screws are not part of this toy and should be discarded for your child's safety.

NOTE

Please keep this parent's guide as it contains important information.

Removing the Packaging Locks:

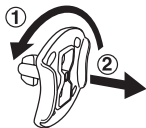

- ① Rotate the packaging lock anticlockwise 90 degrees.
- ② Pull out the packaging lock.

WARNING!

Not to be used by children over 36 months. Insufficient strength. 20kg Max. Regularly check for signs of wear or tear on the snap in or locking devices. If damaged do not use until repaired or replaced. Only to be used under the direct supervision of a competent adult.

- This toy should be used in a safe area e.g indoors, in a private garden, on level flat surfaces and away from any hazards such as cars, stairs, water etc.
- Not for use on pavements or in traffic.
- Adult supervision is advised.
- Please help your child to sit properly on the seat and to use the toy correctly.
- Since skill is required this toy should be used with caution to avoid falls or collisions that could cause injury to the user or third parties.

INSTRUCTIONS

Battery Removal and Installation

1. Make sure the unit is turned **Off**.
2. Find the battery cover located under the Mode Switch. Use a screwdriver to loosen the screw and open the battery cover.
3. Remove old batteries by pulling up on one end of each battery.
4. Install 2 new AA (AM-3/LR6) batteries following the diagram inside the battery box. (For best performance, alkaline batteries or fully charged Ni-MH rechargeable batteries are recommended).
5. Replace the battery cover and tighten the screw to secure.

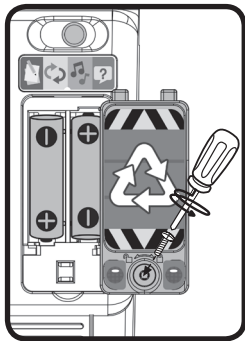

WARNING:

Adult assembly required for battery installation.

Keep batteries out of reach of children.

IMPORTANT: BATTERY INFORMATION

- Insert batteries with the correct polarity (+ and -).
- Do not mix old and new batteries.
- Do not mix alkaline, standard (carbon-zinc) or rechargeable batteries.
- Only batteries of the same or equivalent type as recommended are to be used.
- Do not short-circuit the supply terminals.
- Remove batteries during long periods of non-use.

- Remove exhausted batteries from the toy.
- Dispose of batteries safely. Do not dispose of batteries in fire.

RECHARGEABLE BATTERIES:

- Remove rechargeable batteries from the toy before charging.
- Rechargeable batteries are only to be charged under adult supervision.
- Do not charge non-rechargeable batteries.

Disposal of batteries and product



The crossed-out wheellie bin symbols on products and batteries, or on their respective packaging, indicates they must not be disposed of in domestic waste as they contain substances that can be damaging to the environment and human health.

The chemical symbols Hg, Cd or Pb, where marked, indicate that the battery contains more than the specified value of mercury (Hg), cadmium (Cd) or lead (Pb) set out in the Batteries and Accumulators Regulation.



The solid bar indicates that the product was placed on the market after 13th August, 2005.

Help protect the environment by disposing of your product or batteries responsibly.

VTech® cares for the planet.

Care for the environment and give your toy a second life by disposing of it at a small electricals collection point so all its materials can be recycled.

In the UK:

Visit www.recyclenow.com to see a list of collection points near you.

In Australia & New Zealand:

Check with your local council for kerbside collections.

LABEL APPLICATION

Please securely stick the labels to the toy as indicated below:

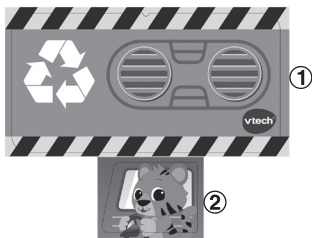

PRODUCT FEATURES

1. Truck Scoop

Move the **Truck Scoop** up and down to drop blocks into the truck and play fun sound effects.

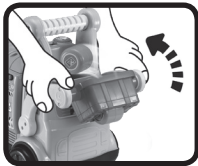
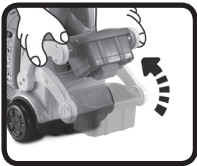

2. Ignition Key

Turn the **Ignition Key** to hear engine sounds.



3. Horn Button

Press the **Horn Button** to hear horn sound effects.

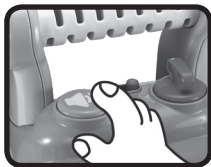

4. Recycling Buttons

Press the **Recycling Buttons** to learn how to help the environment and how to sort objects by plastic, glass and paper.

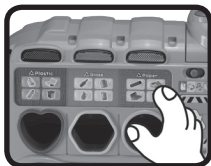

5. Mode Switch

Slide the **Mode Switch** to explore recycling game modes through music, quizzes and more!

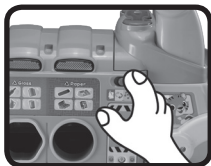

6. Off/Low/High Volume

Slide the **Off/Low/High Volume** switch to the **Low** or **High** volume position to turn the unit on and adjust volume. Slide the switch to the **Off** position to turn off the unit.

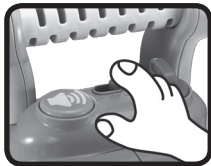

7. 3 Smart Sorting Bins

Insert a block into a **Smart Sorting Bin** to learn colours and shapes.



8. 3 Lights

The 3 lights will light up according to the game play.



9. Storage

Scoop and sort the blocks by shape and colour, then store them in the truck.



10. Automatic Shut-Off

To preserve battery life, the **Ride & Go Recycling Truck** will automatically shut off after several minutes without input. The unit can be turned on again by sliding the **Mode Switch**.

The unit will also automatically turn off when the batteries are very low.

NOTE

If the unit powers down or if the lights fade during play, please install a new set of batteries.

ACTIVITIES

1. Recycle Mode

Learn about recycling objects by colour and material. Put a block into a **Smart Sorting Bin** to also learn shapes.



2. Reuse Mode

Explore different ways to reuse objects and learn about different materials. Press the **Recycling Buttons** or put a block into a **Smart Sorting Bin** to play.



3. Music Mode

Hear songs, melodies and sound effects by pressing the **Recycling Buttons**, inserting blocks into the **Smart Sorting Bins**, moving the **Truck Scoop**, turning the **Ignition Key** and pressing the **Horn Button**.



4. Quiz Mode

Show what you know! Identify objects and sort them correctly by colour and material. Press the **Recycling Buttons** or insert a block into a **Smart Sorting Bin** to answer. Correctly answer five questions in a row to hear a rewarding song and level up. There are three levels in total. Questions will be repeated if the **Truck Scoop**, **Ignition Key** or **Horn Button** are triggered 3 times.



MELODIES

1. The Entertainer
2. Baby Bunting
3. The Wheels on the Bus
4. Looby Loo
5. Funiculi, Funicula
6. Mozart's Piano Sonata in C

SONG LYRICS

Song 1

Recycle, recycle,
Reduce, reuse, recycle!
I drive this truck to pick up stuff,
Like paper, glass and plastic!

Song 2

Three colour bins would like to take your paper,
Plastic and glass!
Thank you pal, for recycling,
Three cheers for you!
Green for glass, and red for plastic, and blue for paper!
Hooray, hooray, hooray, hooray,
Keep up the great work!

Song 3

Take out the recycling, take out the recycling,
Take out the recycling, to the proper bin, to the proper bin!

Song 4

It could be a container, bottle, or pot.

Recycling plastic,

It makes me smile a whole lot!

It could be a container, bottle, or pot.

Recycling plastic,

It makes me smile a whole lot!

Song 5

I pick up plastic, all kinds of plastic,

The strangest plastic that you ever did see!

The green truck drives all around, all around,

The green truck drives all round!

Song 6

Glass, glass, glass,

Makes such loud sounds,

When it smashes on the ground!

We'll sweep it up and put it in the bin,

Glass, glass, glass,

Makes such loud sounds!

Song 7

The glass goes in the green bin,
The glass goes in the green bin,
The glass goes in the green bin,
It's recycling!

Song 8

Where does paper come from?
Wood helps make paper.
Wood comes from trees.
When trees are planted.
They grow and grow and grow,
Just like you do too!

Song 9

Each morning my neighbour reads the newspaper,
And then they go and put it in the bin each afternoon!
When I come to pick it up in my green truck,
It's nicely stacked and sorted, what good luck!

CARE & MAINTENANCE

1. Keep the unit clean by wiping it with a slightly damp cloth.
2. Keep the unit out of direct sunlight and away from any direct heat sources.
3. Remove the batteries if the unit will not be in use for an extended period of time.
4. Do not drop the unit on hard surfaces and do not expose the unit to moisture or water.

TROUBLESHOOTING

If for some reason the unit stops working or malfunctions, please follow these steps:

1. Turn the unit Off.
2. Interrupt the power supply by removing the batteries.
3. Let the unit stand for a few minutes, then replace the batteries.
4. Turn the unit On. The unit should now be ready to use again.
5. If the unit still does not work, install a new set of batteries.

If the problem persists, please contact our Consumer Services Department, and a service representative will be happy to help you.

CONSUMER SERVICES

Creating and developing **VTech®** products is accompanied by a responsibility that we at **VTech®** take very seriously. We make every effort to ensure the accuracy of the information, which forms the value of our products. However, errors sometimes can occur. It is important for you to know that we stand behind our products and encourage you to call our Consumer Services Department with any problems and/or suggestions that you might have. A service representative will be happy to help you.

UK Customers:

Phone: 0330 678 0149 (from UK) or +44 330 678 0149 (outside UK)

Website: www.vtech.co.uk/support

Australian Customers:

Phone: 1800 862 155

Website: support.vtech.com.au

NZ Customers:

Phone: 0800 400 785

Website: support.vtech.com.au

PRODUCT WARRANTY/ CONSUMER GUARANTEES

UK Customers:

Read our complete warranty policy online at vtech.co.uk/warranty.

Australian Customers:

VTECH ELECTRONICS (AUSTRALIA) PTY LIMITED –
CONSUMER GUARANTEES

Under the Australian Consumer Law, a number of consumer guarantees apply to goods and services supplied by VTech Electronics (Australia) Pty Limited. Please refer to vtech.com.au/consumerguarantees for further information.

**Visit our website for more
information about our products,
downloads, resources and more.**

www.vtech.co.uk
www.vtech.com.au

